



VATHiN



VATHiN

www.vathin.com
marketing@vathin.com

1st floor, Building 12 , No.9, West Chuanqi Road, Jiuhua
Economic and Technological Development Zone, Xiangtan
411100, China



Vathin Single-Use Flexible Cystoscope HD Cystoscope Series

Experience Next-level HD Imaging

Designed For Clarity and Ease

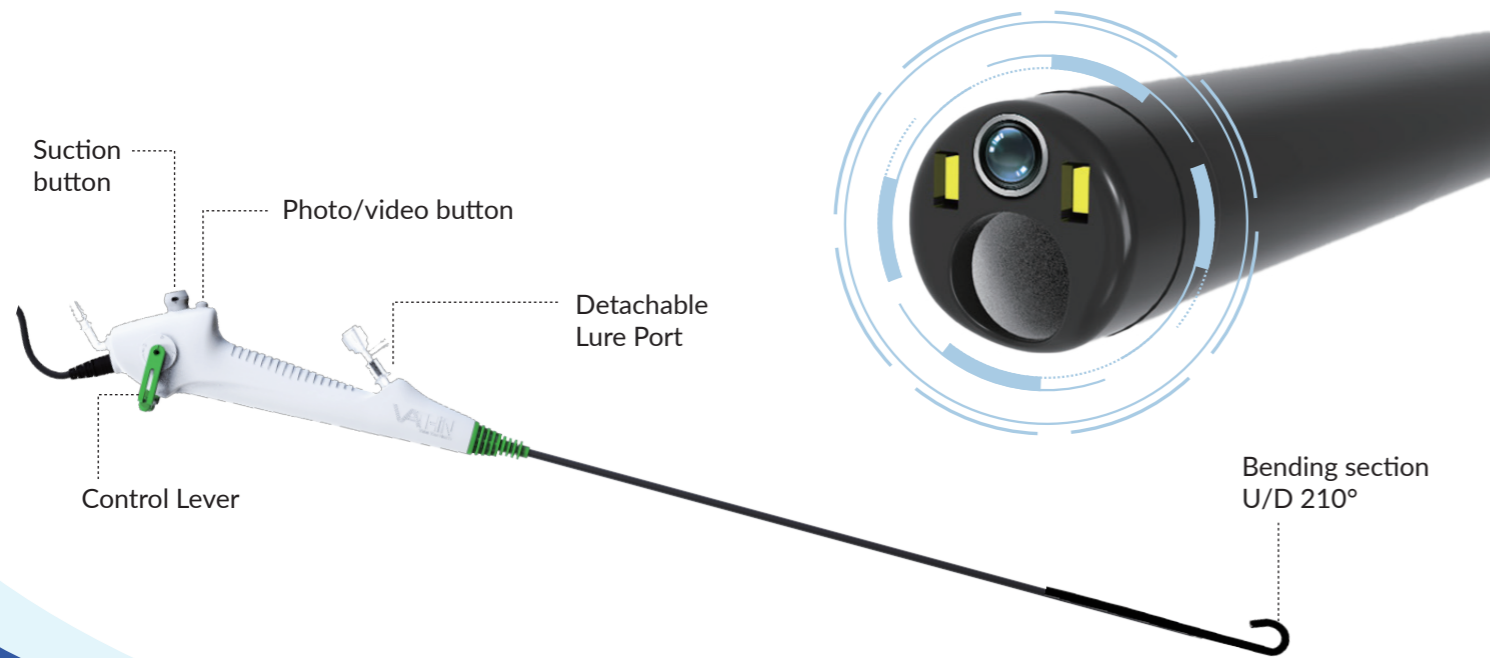

New Generation HD Imaging System

MegaPixel Camera

Vathin HD Bronchoscope Series Implement HD camera, with 720*1080 resolution, 3-100mm depth of view that help produce sharper images, aiding in precise diagnosis and effective treatment.

2 LED light source

Integrates more advanced LED lighting to improve visibility in various conditions within the bronchi.

15.6" Full-HD Monitor

Vathin HD Scope Series work together with DVM-D Monitor. 15.6" wide screen with 1920*1080 pixels resolution and 3-100mm depth-of-field delivers superior visualization for demanding clinical scenarios.

Key Benefits

- ✓ **Sharper, clearer, state-of-art HD imaging system** offers precise visualization in cystoscopy.
- ✓ **Superior maneuverability:** wide bending angle of 210° enables ideal maneuver for inspection or treatment, even in challenging areas such as the bladder neck.
- ✓ **Options for large working channel:** 2.4mm/7.2Fr working channel is available which provides better irrigation and easier instrument insertion.
- ✓ **Ergonomic design:** light weighted scope designed for ease of use.
- ✓ **Streamline your workflow:** single-use scope which is always available whenever it is needed. No waiting time, no risk of damage.
- ✓ **Cost saving:** Reduces costs and complexity with a single-use solution—no repairs, no reprocessing, no hidden cost.

Specification

HD Cystoscope Series

Model	CY-E2E01	CY-E2E01R	CY-E2F01	CY-E2F01R	CY-E2G01	CY-E2G01R	CY-S2E01	CY-S2E01R
Insertion Tube OD	4.9mm/14.7Fr		5.1mm/15.3Fr		5.3mm/15.9Fr		4.9mm/14.7Fr	
Working Channel	2mm/6Fr		2.2mm/6.6Fr		2.4mm/7.2Fr		2mm/6Fr	
Deflection	Standard	Reverse	Standard	Reverse	Standard	Reverse	Standard	Reverse
Suction	NA						Y	
Bending Section	U210° / D210°							
Working Length	400mm							
Resolution	720x1080 plx							
Field of View	110°±15%							
Depth of field	3-100mm							

DVM-D MONITOR

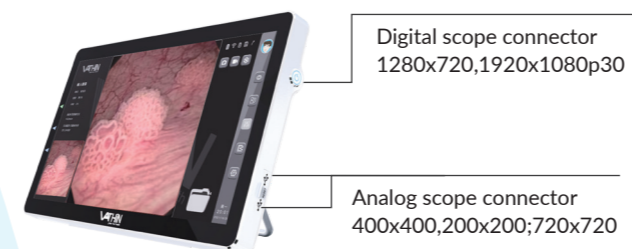

Model	DVM-D
Display resolution	1920*1080 (full HD 60Hz)
Display Type	15.6" FHD Color TFT-LCD
Dimension WxHxT	382 mmx 238mm x 44.5mm
Weight	3 kg
Storage Capacity	64GB

- ✓ High definition imaging system.
- ✓ Large screen for easier visualization.
- ✓ Simultaneous Dual-Scope Display offers
- ✓ Ideal clinical observation.